



Finishing cutter for Aluminium

PFAL

Volume 1



KEY FEATURES: PHOENIX PFAL

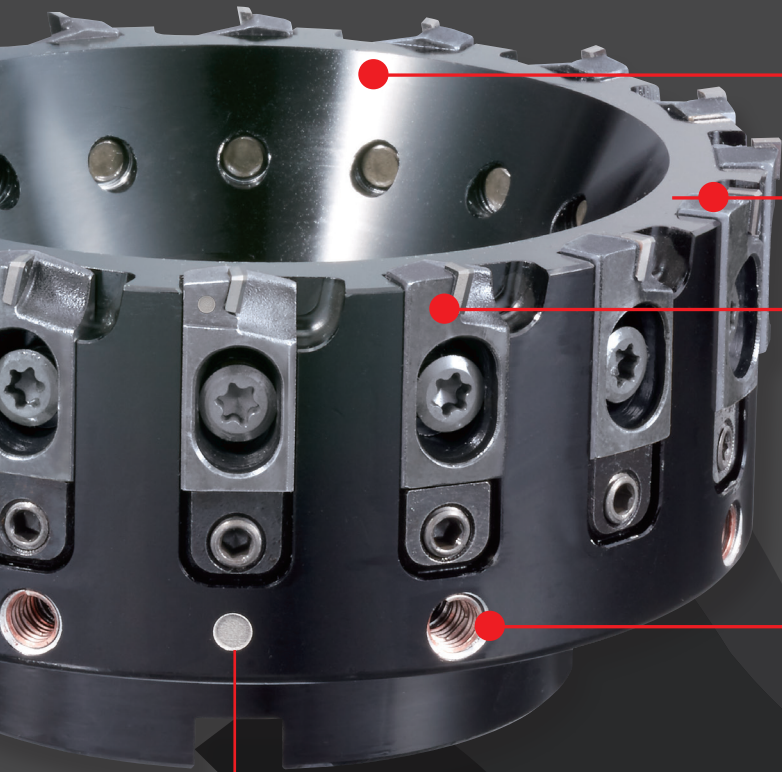

- 1** Excellent balance
- 2** High efficiency
- 3** PCD integrated blades
- 4** High precision balancing

Wiper blade position indicator



Wiper blade

Wiper blade indicator



Normal blade

WIPER BLADE

Enables superior surface finish

Mount in designated position

NORMAL BLADE

Enables stable milling with multiple blades configuration

Mount in any cutter body slots (except wiper blade position)

Incredibly lightweight with Aluminum body construction

Broad size lineup to accommodate various cutting environment, even small machining centers.

Standardized wiper blade

The wiper blade enables a superior surface finish. One wiper blade is used per cutter body; for mounting in the designated position. The wiper blade can be recognized from the indicator on the blade

Normal blade

The normal blades are configured for stable milling. The normal blades are mounted in any of the cutter body slots except for the wiper blade position (see image).



PFAL Ø160 with BT30

Bore diameters of Ø25.4 and Ø27 are standard offering in the PFAL Ø160 cutter lineup

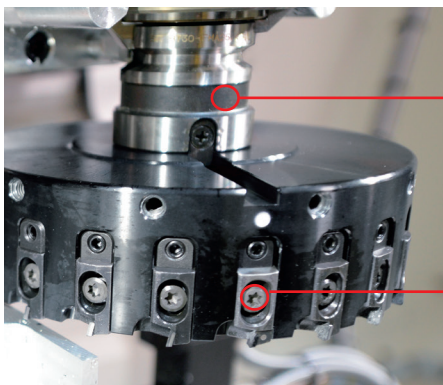

Face mill arbor BT30-FMA25.4-45 Weight 0,90 kg	+	PFAL Ø160 PFAL04R160M25.4-20 Weight 1,98 kg	=	Total Weight 2,88 kg
---	---	--	---	---------------------------------------

Component examples

Aluminium automotive component solutions

- Clutch housing
- Transmission case
- Cylinder head
- Cylinder block

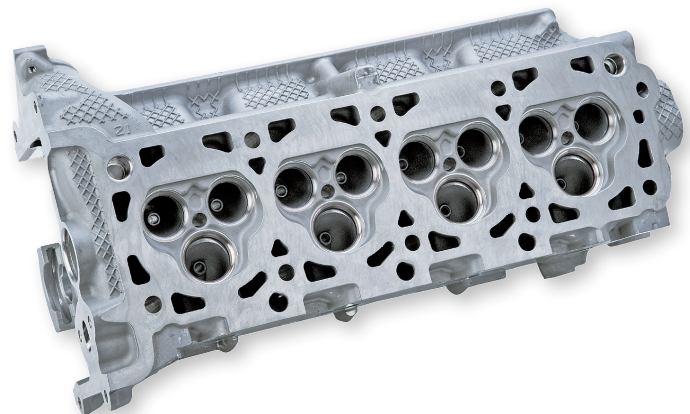

Spare parts compatibility

The spare parts are compatible with all cutter sizes. The rigidity is improved for the large clamping screw M6 and the eady cutting edge adjustment reduces the required setup time.



PFAL BORE

Milling | Indexables



- Face milling finishing cutter for aluminium
- PCD blades
- Bore type
- 50 -160 mm

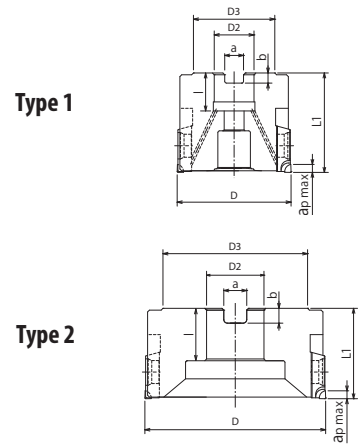
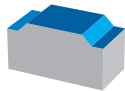

EDP	Designation	Z	D	D3	D2	L1	l	a	b	Type	Price
7803600	PFAL04R050M16-5	5	50	40	16	55	20	8,4	5,6	1	
7803601	PFAL04R063M22-6	6	63	45	22	55	21	10,4	6,3	1	
7803602	PFAL04R063M22-8	8	63	45	22	55	21	10,4	6,3	1	
7803604	PFAL04R080M27-8	8	80	70	27	50	28	12,4	7	2	
7803606	PFAL04R080M27-10	10	80	70	27	50	28	12,4	7	2	
7803608	PFAL04R100M27-8	8	100	80	27	50	28	12,4	7	2	
7803610	PFAL04R100M32-8	8	100	80	32	50	28	14,4	8,2	2	
7803612	PFAL04R100M27-12	12	100	80	27	50	28	12,4	7	2	
7803614	PFAL04R100M32-12	12	100	80	32	50	28	14,4	8,2	2	
7803616	PFAL04R125M27-10	10	125	80	27	50	28	12,4	7	2	
7803618	PFAL04R125M40-10	10	125	85	40	63	30	16,4	9,2	2	
7803620	PFAL04R125M27-16	16	125	80	27	50	28	12,4	7	2	
7803622	PFAL04R125M40-16	16	125	85	40	63	30	16,4	9,2	2	
7803624	PFAL04R160M27-12	12	160	80	27	50	28	12,4	7	2	
7803625	PFAL04R160M40-12	12	160	85	40	63	30	16,4	9,2	2	
7803630	PFAL04R160M27-20	20	160	80	27	50	28	12,4	7	2	
7803627	PFAL04R160M40-20	20	160	85	40	63	30	16,4	9,2	2	

Milling | Indexables



90 degrees

Accessories & spare parts

Applicable cutter	Clamping screw		Wedge		Clamping screw for wedge		L-wrench (for wedge)		T-Handle wrench (for insert)	
Ø 50~160	7808125	FS60620 (Torx25)	7808143	W12-06	7808142	WS0617	7808231	3MM-L	7808211	T25-T

PFAL INSERTS

Milling | Indexables



- Face milling finishing cutter for aluminium
- PCD blades

Type 1

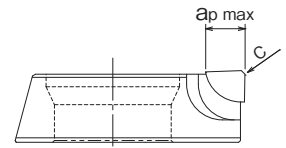

Normal blade

Type 2

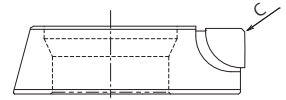

Wiper blade

EDP	Designation	Z	C	Type	ap max	Grade	P		M		K		N		S		H		Price
							dry	👉	dry	👉	GG	GGG	dry	👉	dry	👉	dry	👉	
7820500	FR1204	1	0,4x45°	1	4	DP010						●	●						
7820502	FR1206	1	0,4x45°	1	6	DP010						●	●						
7820501	FR1204-W	1	0,4x45°	2	-	DP010						●	●						

Cutting conditions

Work Material	Component	Material	Application	Vc (m/min)		Feed per Tooth fz (mm/t)	Depth of cut ap (mm)
				BT30	BT40, BT50 HSK63		
N	Aluminium Alloy	~ 12% Si	A7075, A5052, A2017, ADC12	Semi-finishing	1.000	2.000	0.08 (0.05 ~ 0.10)
				Finishing	(800~2.000)	(1.000~5.000)	0.06 (0.05 ~ 0.08)
	Aluminium Alloy	~ 13% Si	AC9A, AC98	Semi-finishing	600 (400 ~ 800)		0.08 (0.05 ~ 0.10)
				Finishing			0.06 (0.05 ~ 0.08)



CUTTING DATA

Milling | Indexables

BT30 high efficiency milling on BT30 with PFAL Ø160

The use of a large-diameter cutter allows processing of a wide area in one pass with no overlap marks. Stable and high quality surface finish was achieved for semi-finishing and finishing even in small machining centers such as the BT30.

Tool	PFAL04R160M25.4-20 Ø160x20 flutes	
Application	Semi-finishing	Finishing
Work material	ADC12	
Cutting speed	1.000 m/min(2.000 min ⁻¹)	2.000 m/min(4.000 min ⁻¹)
Feed	3.200 mm/min(0,08mm/t)	6.400 mm/min(0,08mm/t)
Depth of cut	ap=2mm ae=100mm	ap=0,2mm ae=100mm
Coolant	Water soluble	
Machine	Vertical Machining Center	
Surface Roughness	Ra=0,25µm Rz=1,22µm	Ra=0,12µm Rz=0,96µm



High precision milling of aluminium component

The PFAL cutter had doubled milling efficiency without chattering, enabling an excellent surface finish.

Tool	PFAL04R080M25.4-10 Ø80x10 flutes	Competitor (Ø80x6 flutes)
Work Material	ADC12	
Cutting Speed	3.000 m/min(12.000 min ⁻¹)	
Feed	14.400 mm/min (0,12mm/t)	7.200 mm/min (0,1mm/t)
Depth of Cut	ap=0,5mm ae=53mm	
Coolant	Water soluble	
Machine	Horizontal Machining Center	
Surface Roughness	Ra=0.17 ~ 0.22µm Rz=1.08 ~ 1.24µm	

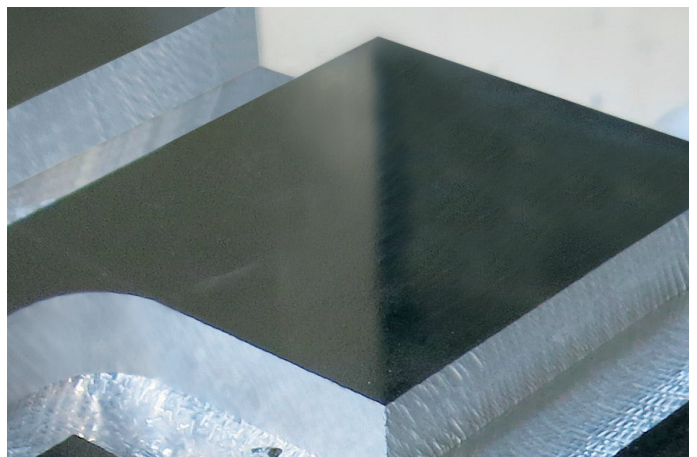

CUTTING DATA

Milling | Indexables

High precision milling of aluminium component

Semi-finishing and finishing took place with the BT30 small machining center. The PFAL cutter was able to meet the required surface roughness in both processes. Moreover, the number of passes was reduced from 2 to 1 during both semi-finishing and finishing, shortening machining time.

Tool	PFAL04R063M22-6 Ø63x6 flutes	
Application	Semi-finishing	Finishing
Work Material	ADC12	
Cutting Speed	1.000 m/min (5.000 min ⁻¹)	1.500 m/min (7.500 min ⁻¹)
Feed	3.000 mm/min (0,1mm/t)	4.500 mm/min (0,1mm/t)
Depth of Cut	ap=2mm ae=34mm	ap=0,2mm ae=34mm
Coolant	Water soluble	
Machine	Horizontal Machining Center	
Surface Roughness	Ra=0,08µm Rz=0,7µm	Ra=0,05µm Rz=0,3µm

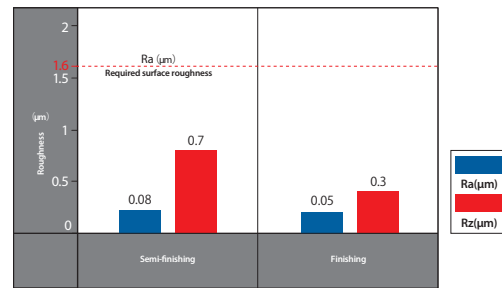
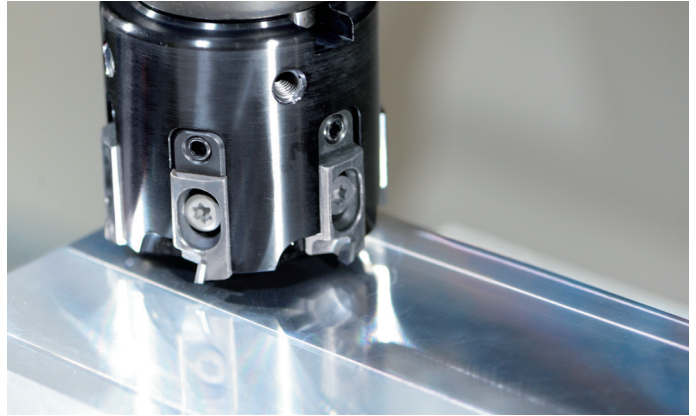

Analysis of cutting chip shape

The cutter body must avoid direct contact with cutting chips. Cutting chips are processed through the blade's chip pocket to prevent them from coming into contact with the cutter body.

The cutting chip does not come in direct contact with the body!

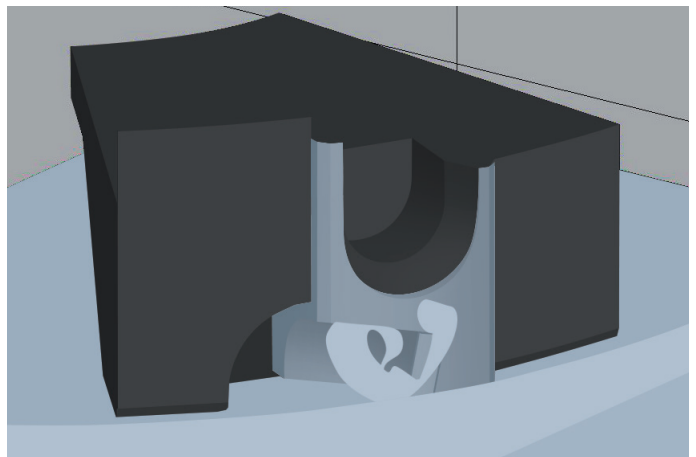

Image of chip evacuation

Instructions for adjusting the cutting edge height

1 Confirm wedge position

Check and ensure that all wedges are in the correct position. Make adjustments when necessary.



Correct



Incorrect

2 Mounting of blades

Mount one wiper blade (FR1204-W) to the wiper blade position indicator and the normal blades (FR1204 or FR1206) to the remaining positions. Using the T-Wrench [A], tighten the clamp screw completely to 10Nm.

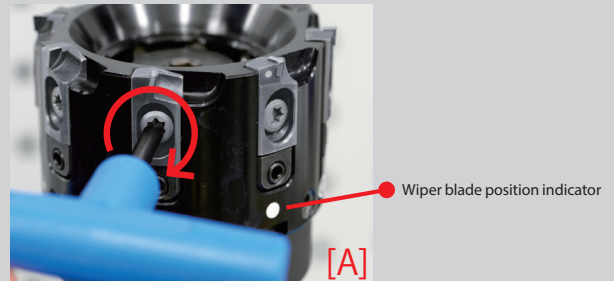

3 Measurement of cutting edge height

Measure all of the cutting edge heights and determine the highest normal cutting edge.

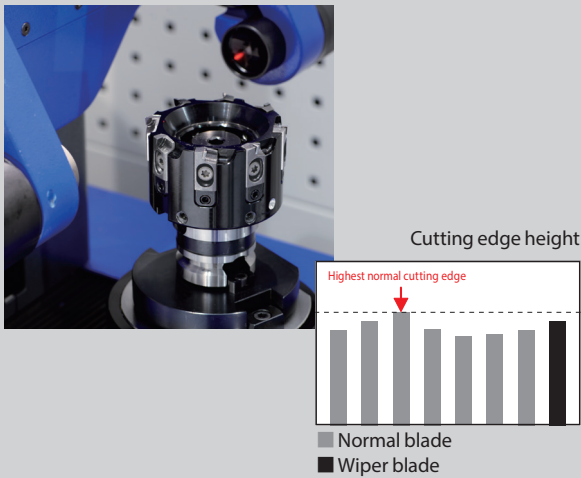

4 Adjustment of normal blades

Adjust all other normal cutting edges to match the highest normal cutting edge height. The offset should be within 0.005mm. To lift the wedges, use the L-Wrench [B] to turn the wedge screw clockwise.

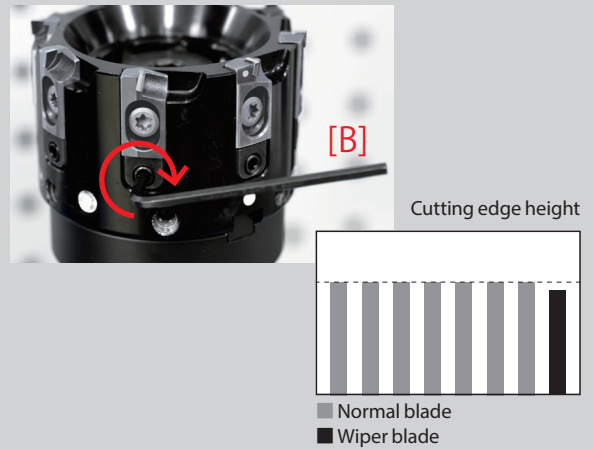

5 Adjustment of wiper blade

Use the L-Wrench [B] to adjust the wiper blade so that it is 0.02 - 0.04mm higher than the other normal blades.

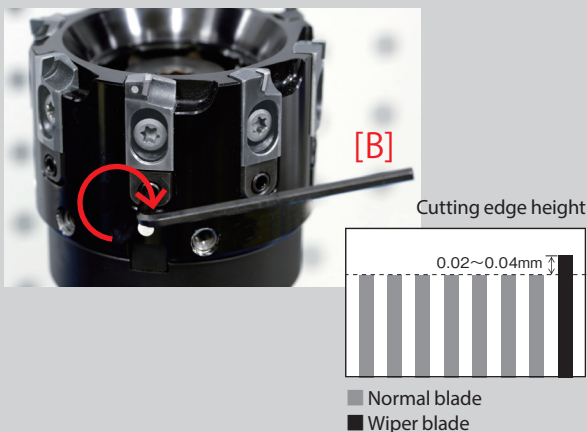

Cutting edge position of the wiper blade

The wiper blade is automatically set to be 0.8mm closer to the interior than the normal blade. Based on this design, only the bottom of the wiper edge is used during processing, thus enabling a high quality surface finish even in high depth (ap) milling.

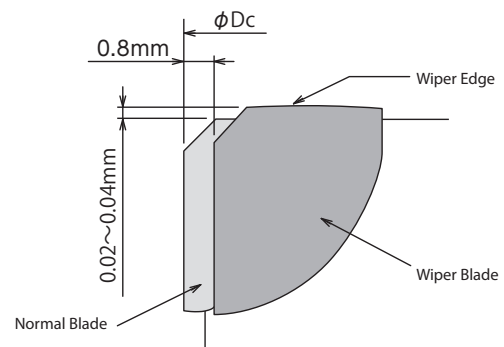

TECHNICAL DATA

Milling | Indexables

Spare parts & accessoires

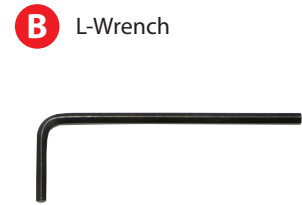
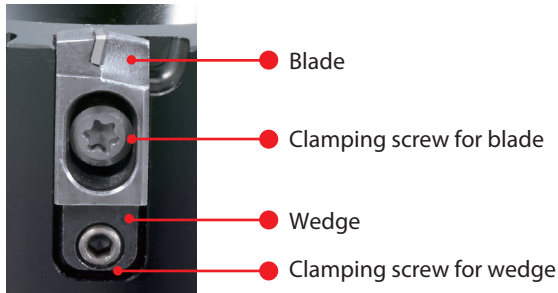

IMPORTANT NOTE !

Blades can be adjusted by lifting upward only

Maximum adjustment is 0.6mm

When the maximum adjustment limit is reached, remove the blade and start over from step 1

When measuring the edge height using a contact tool presetter with a touch probe

Please be cautious to not damage the PCD edge

Temporary tightening is not required. Cutting edge height can be adjusted after complete tightening of the clamping screw, making the setup process quick and effortless.

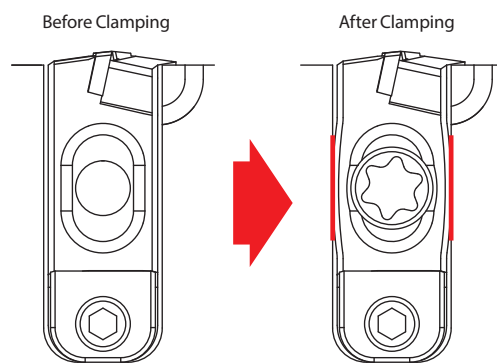

The tightening of the clamping screw pushes sides of the blade outward, locking it tightly in place with the cutter body

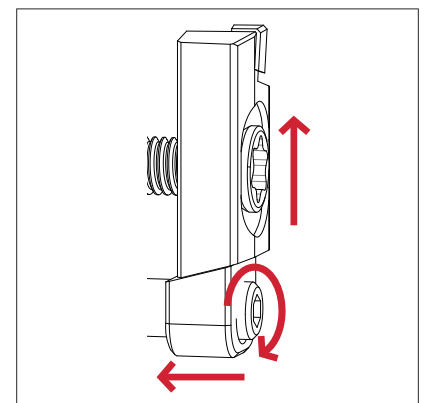

After tightening the clamping screw, the blade is locked into position secured by the wedge taper. The wedge assures a fix and unmovable blade position during machining.

SWEDEN

Branch office of OSG SCANDINAVIA
Singelgatan 7
212 28 Malmö
Sweden
Tel: +46 40 41 22 55
osg@osg-scandinavia.com

OSG SCANDINAVIA

(For Scandinavian countries)
Langebjergvaenget 16
4000 Roskilde
Denmark
Tel: +45 46 75 65 55
osg@osg-scandinavia.com

OSG NETHERLANDS

Bedrijfsweg 5
3481 MG Harmelen
The Netherlands
Tel: +31 348 44 2764
info@osg-nl.com

OSG UK

Kelsey Close, Attleborough Fields Ind Est,
CV11 6RS, Nuneaton
United Kingdom
Tel: +44 (0) 1827 720 013
uk_sales@osg-uk.com

OSG EUROPE LOGISTICS

Avenue Lavoisier 1
B-1300 Z.I. Wavre - Nord
Belgium
Tel: +32 10 23 05 07
info@osgeurope.com

OSG BELUX

Avenue Lavoisier 1
B-1300 Z.I. Wavre - Nord
Belgium
Tel: +32 10 23 05 11
info@osg-belgium.com

OSG IBÉRICA

Bekolarra 4
E - 01010 Vitoria-Gasteiz
Spain
Tel: +34 945 242 400
osg.iberica@osg-ib.com

OSG FRANCE

Parc Icade, Paris Nord 2
Immeuble "Le Rimbaud"
22 Avenue des Nations
CS66191 - 93420 Villepinte
France
Tel: +33 1 49 90 10 10
sales@osg-france.com

OSG ITALY

Via Ferrero, 65 A/B
I - 10098 Rivoli
Italy
Tel: +39 0117705211
info@osg-italia.it



OSG IN EUROPE

CZECH REPUBLIC, SLOVAKIA, HUNGARY

OSG Europe Logistics S.A.
Slovakia, organizačná zložka
Račianska 22/A, Bratislava 831 02
Slovakia
Tel.: +421 24 32 91 295
info@osgeurope.com

OSG POLAND

ul. Spółdzielcza 57
05-074 Halinów
Polska
Tel: +22 760 82 71
Mob. +48 570 677 711
osg@osg-poland.com

OSG ROMANIA SRL

25C, Bucuresti-Magurele Street (Sector 5)
051431 Bucuresti
România
Tel: +40 21 322 07 47
info@osgromania.ro

OSG TURKEY

Rami Kişla Cad.No:56 Eyüp
Istanbul 34056
Turkey
Tel: +90 212 565 24 00
Fax: +90 212 565 44 00
info@osg-turkey.com

Vischer & Bolli AG

Machining and Workholding
Im Schossacher 17
CH-8600 Dübendorf
Switzerland
Tel.: +41 44 802 15 15
info@vb-tools.com

OSG GERMANY

Karl-Ehmann-Str. 25
D - 73037 Göppingen
Germany
Tel: +49 7161 6064 - 0
Fax: +49 7161 6064 - 444
info@osg-germany.de



shaping your dreams

OSG EUROPE LOGISTICS

Avenue Lavoisier 1
B-1300 Z.I. Wavre - Nord - Belgium
Tel: +32 10 23 05 07
info@osgeurope.com

OSG POLAND Sp. z.o.o.

Spółdzielcza 57
05-074 Halinów - Poland
Tel: +22 760 82 71
osg@osg-poland.com

OSG ROMANIA SRL

25C, Bucuresti-Magurele Street (Sector 5)
051431 Bucuresti - România
Tel: +40 21 322 07 47
info@osgromania.ro

OSG BELUX

Avenue Lavoisier 1
B-1300 Z.I. Wavre - Nord - Belgium
Tel: +32 10 23 05 11
info@osg-belgium.com

OSG GERMANY

Karl-Ehmann-Str. 25
D - 73037 Göppingen - Germany
Tel: +49 7161 6064 - 0
Fax: +49 7161 6064 - 444
info@osg-germany.de

AUSTRIA

Branch office of OSG GERMANY
Messestraße 11
A-6850 Dornbirn
Tel: +49 7161 6064-0
info@osg-germany.de

OSG FRANCE

Parc Icade, Paris Nord 2
Immeuble "Le Rimbaud"
22 Avenue des Nations
CS66191 - 93420 Villepinte - France
Tel: +33 1 49 90 10 10
sales@osg-france.com

OSG SCANDINAVIA

(For Scandinavian countries)
Langebjergvaenget 16
4000 Roskilde - Denmark
Tel: +45 46 75 65 55
osg@osg-scandinavia.com

OSG ITALIA

Via Ferrero, 65 A/B3
I - 10098 Rivoli - Italy
Tel: +39 0117705211
info@osg-italia.it

OSG NETHERLANDS

Bedrijfsweg 5 - 3481 MG Harmelen
Tel: +31 348 44 2764
info@osg-nl.com

SWEDEN

Branch office of OSG SCANDINAVIA
Singelgatan 7
212 28 Malmö - Sweden
Tel: +46 40 41 22 55
osg@osg-scandinavia.com

Vischer & Bolli AG

Machining and Workholding
Im Schossacher 17
CH-8600 Dübendorf
T +41 44 802 15 15
info@vb-tools.com

OSG UK

Kelsey Close, Attleborough Fields Ind Est,
CV11 6RS, Nuneaton, United Kingdom.
Tel: +44 1827 720 013
uk_sales@osg-uk.com

OSG IBERICA

Bekolarra 4
E - 01010 Vitoria-Gasteiz - Spain
Tel: +34 945 242 400
osg.iberica@osg-ib.com

CZECH, SLOVAKIA, HUNGARY

OSG Europe Logistics S.A.
Slovakia organizacna zlozka
Racianská 22/A, SK-83102 Bratislava
Slovakia
Tel. +421 24 32 91 295
Orders-osgsvk@osgeurope.com

OSG TURKEY

Rami Kışla Cad.No:56 Eyüp
Istanbul 34056 - Turkey
Tel+90 212 565 24 00
Fax: +90 212 565 44 00
info@osg-turkey.com

OSG EUROPE LOGISTICS S.A.

10/2017 - All rights reserved. © OSG Europe 2017.

The contents of this catalogue are provided to you for viewing only. They are not intended for reproduction either in part or in whole in this or other medium. They cannot be copied, used to create derivation work or used for any reason, by means without the express, written permission of the copyright owner. If prices are stated, they are netto unit-prices and any eventual tax(es) have to be added. The company is not responsible for any printing error in technical, price and/or any other data.

Tool specifications subject to change without notice.

www.osgeurope.com

